

# EXT-POE3H

## Extender EXT-POE3 in hermetic enclosure



CODE: **EXT-POE3H** v1.0/I  
 TYPE: **Extender EXT-POE3 in hermetic enclosure**

EN

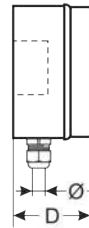
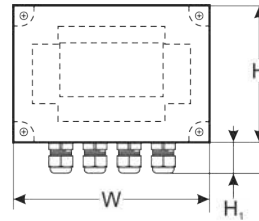

### Features:

- The output voltage range 44-57VDC
- Power from PoE switch
- The PoE IN input compliant with the IEEE802.3af/at standard
- The PoE OUT 1/2 output compliant with the IEEE 802.3af/at standard (selectable by switch)
- Output PoE OUT 3 – passive
- Increases Ethernet and PoE power range by 100 meters
- Designed for 10Mbit/s and 100Mbit/s network
- Pole mounting option (requires the OZB1 adapter - optional accessory)
- The possibility to turn off power to the PoE OUT1 / 2 ports
- LED optical signalization
- protections:
  - surge protection (PoE input)
  - OLP overload protection
  - SCP short circuit protection
  - IP56 hermetic enclosure
- warranty – 1 year from the production date

### DESCRIPTION

The **EXT-POE3H extender** is a device designed to increase the PoE and Ethernet range by additional 100 meters using UTP Cat. 5/5e cable. The Extender can be powered using a PoE switch or another PoE-compliant device (PoE IN input). The output voltage and data are available at the PoE OUT1 and OUT2 outputs designed for connecting cameras or other IP devices using PoE power supply. The maximum load current is 0,4A (see Tab.2). The PoE OUT1, PoE OUT2, PoE OUT3 port are supplied over 4/5 (+) and 7/8 (-) pairs, which, according to the Ethernet standard, are not used for data transmission (data transmission uses 1/2 and 3/6 twisted pairs).

### TECHNICAL DATA

Supply voltage	compliant with 802.3af/at (44÷57VDC)
Current consumption by PSU systems	<30mA
Module power	20W max.
Output voltage	Applying power
Output current	0,4A PoE ports OUT1/2, 0,3A/port ( $\Sigma=0,4A$ max.)
The PoE IN input power supply pairs	1/2 (+) 3/6 (-) 4/5 (+) 7/8 (-)
The PoE OUT1/2 output power supply pairs	4/5 (+) 7/8 (-)
Overload protection OLP	PoE OUT1/2: 105% ÷ 150% of nominal output current, automatic recovery
Short circuit protection SCP	PoE OUT3: PTC 0,5A, polymer fuse
LED operation indication	Yellow LAN LED - indicating the LAN connection status Green PoE LED - presence of input/output voltage
Range of operating temperatures	-25°C÷50°C
External dimensions	W=158, H=118, D=77 [+/- 2 mm]
Height glands	H <sub>1</sub> =25 [mm]
The number of cable glands/ Ø cables	4 pcs. / 4÷8mm
Connectors: - IN/OUT PoE	RJ45 8P8C
Net/gross weight	0,42kg / 0,48kg
Storage temperature	-25°C...+60°C
Declarations, warranty	CE, RoHS, 1 year from the production date